

8  
7  
6  
5  
4  
3  
2  
1

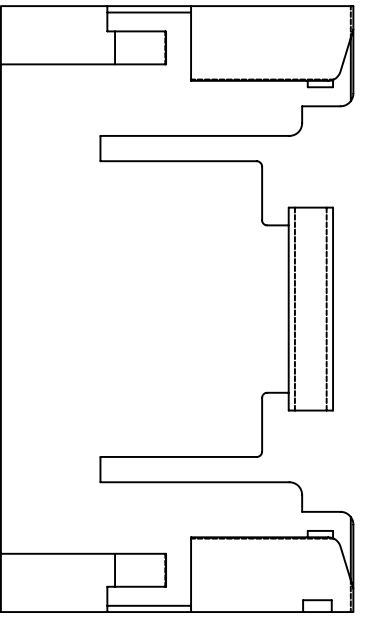
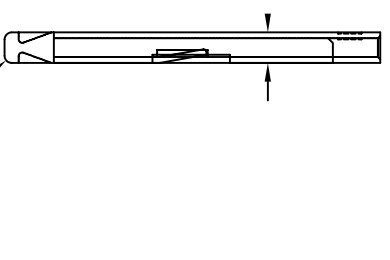
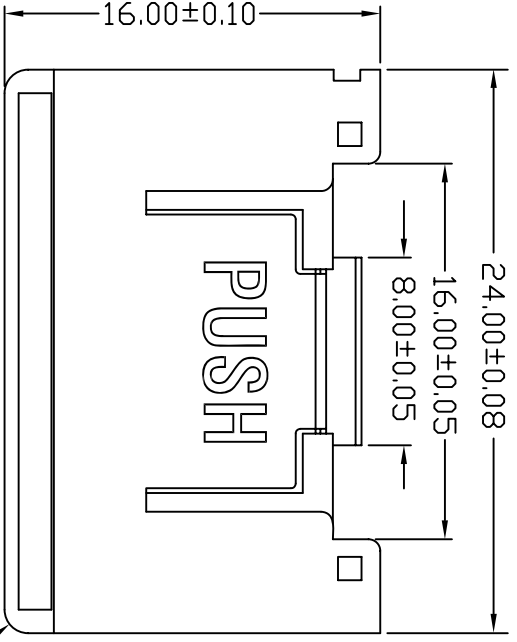
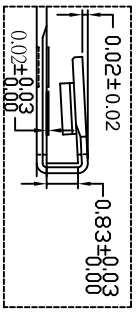
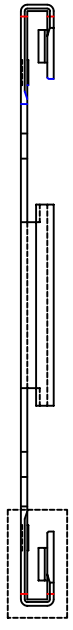

- NOTE
1. MATERIAL
    - 1.1 HOUSING:PBT UL94V-0
    - 1.2 SHELL:STAINLESS STEEL
  2. FINISH
    - 2.1 INSERT FORCE OF RS-MMS CARD:5N MAX
    - 2.2 RETENTION FORCE OF RS-MMS CARD: 20N MIN
  - 3.ELECTRICAL CHARACTERISTIC
    - 3.1.OPERATING TEMPERATURE: -25°C~ 85°C
    - 3.2.OPERATING HUMIDITY:10% TO 95% RH
    - 3.3.STORAGE TEMPERATURE: -25°C~ 85°C
    - 3.4.STORAGE HUMIDITY:10% TO 95% RH

1-132-400069-001  
PART NUMBER

**GMT**  
GLOBEMASTER  
TECHNOLOGIES CO.,LTD.

RS-MMC ADAPTER

TOLERANCES UNLESS OTHERWISE SPECIFIED: DWN	Doris.Tsai
0 PLC ± 0.30	13-MAR-2007
1 PLC ± 0.30	Kevin.Ke
2 PLC ± 0.30	13-MAR-2007
3 PLC ± 0.30	Jacky.Lin
ANGLES ± 5°	13-MAR-2007

FINISH	SEE NOTE	PRODUCT SPEC	SEE NOTE
WEIGHT	XX GRAM		

LTR	REVISION RECORD	ECN	DWN	CHK	DATE
A	FIRST RELEASED	GMT200703-132	03/13		

CUSTOMER DRAWING